

Miniature Inch Series

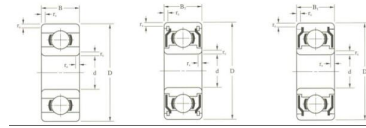

Número de producto			Exterior	Ancho	Ancho	Radio	Capacidad de carga (N)		Velocidad máxima		Tipo de jaula	Pelota Complemento	
Abierto	Escudo	Sellado	Diámetro D(mm)	B milímetro	B1 milímetro	rs(min) milímetro	Dinámico (milímetros)	Estático Corazón (milímetros)	Grasa *1000RPM	Aceite *1000RPM		CANTIDAD Z	Tamaño Dw
R16	R16 ZZ	R16 2RS	50.80	9.53	12.70	0.80	10070	5810	9	12	RJ	10	6.35
R14	R14 ZZ	R14 2RS	47.63	9.53	12.70	0.80	10070	5810	13	17	RJ	10	6.35
R12	R12 ZZ	R12 2RS	41.28	7.94	11.11	0.80	9384	5057	17	21	RJ	9	6.35
R10	R10 ZZ	R10-2RS	34.93	7.14	8.73	0.80	5988	3287	21	25	RJ	10	4.76
R8	R8 ZZ	R8 2RS	28.58	6.35	7.94	0.40	5108	2413	27	32	J	8	4.76
R6	R6 ZZ	R6 2RS	22.23	5.56	7.14	0.40	3332	1422	32	38	J	7	3.97
R1810*	R1810 ZZ*	R1810 2RS*	12.70	3.97	3.97	0.15	542	276	40	48	W	12	1.20
R4A	R4A ZZ	R4A 2RS	19.05	5.56	7.14	0.40	2336	896	36	43	J	6	3.50
R4*	R4 ZZ*	R4 2RS*	15.88	4.98	4.98	0.30	1480	621	38	45	J	8	2.38
R188*	R188 ZZ*	R188 2RS*	12.70	3.18	4.76	0.15	1082	442	40	50	J	8	2
R168*	R168 ZZ*	R168 2RS*	9.53	3.18	3.18	0.10	373	172	48	56	W	11	1
R3A	R3A ZZ	R3A 2RS	15.88	4.98	4.98	0.30	1480	621	38	45	J	8	2.38
R3*	R3 ZZ*	R3 2RS*	12.70	3.97	4.98	0.30	1301	488	43	53	J	7	2.38
R166*	R166 ZZ*	R166 2RS*	9.53	3.18	3.18	0.10	709	272	50	60	W	8	1.59
R1-5*	R1-5 ZZ*		7.94	2.78	3.57	0.15	582	176	60	71	W	6	1.59
R144*	R144 ZZ*	R144 2RS*	6.35	2.38	2.78	0.10	284	96	67	80	W	7	1
R2-5*	R2-5 ZZ*	R2-5 2RS*	7.94	2.78	3.57	0.10	558	180	60	67	W	6	1.59
R2-6*	R2-6 ZZ*	R2-6 2RS*	9.53	2.78	3.57	0.15	640	227	53	63	W	7	1.59
R2*	R2 ZZ*	R2 2RS*	9.53	3.97	3.97	0.30	631	219	56	67	J	7	1.59
R2A	R2A ZZ	R2A 2RS	12.70	4.37	4.37	0.30	640	227	53	63	J	7	1.59
R155*	R155 ZZ*	R155 2RS*	7.94	2.78	3.18	0.10	359	150	53	63	W	10	1
R156*	R156 ZZ*	R156 2RS*	7.94	2.78	3.18	0.10	359	150	53	63	W	10	1

Miniature Inch Series

R133	R133 ZZ*		4.76	1.59	2.38	0.10	189	60	80	95	W	7	0.80
------	-------------	--	------	------	------	------	-----	----	----	----	---	---	------